

Scale 10 Chains
to an Inch

(73)

Chas. Bearer's
Joseph Miller
Barney Barum

Post Oak 9x 5m
N. W. corner
of the land

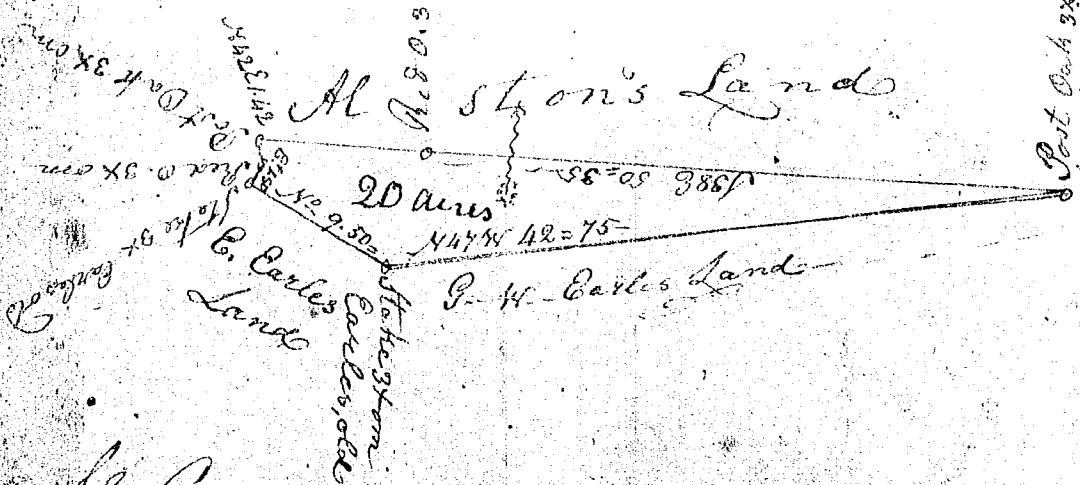

S. Carolina

Pursuant to a warrant from
 Wm. L. Thomas Com^r Location in the
 District of Greenville, dated the 23^d day
 of Nov^r 1812 - I have admeasured & laid
 out unto George Washington Charles, a tract
 of land containing Twenty acres - Situate in
 the said District, on a branch of Reedy Riv^r
 Bounded by a line running S E wardly
 by Alston's land, N by E. Charles land
 by G. W. Charles Land, & hath such form & marks
 as the above plat represents -

Surveyed the 15th day of Dec^r 1812

Wm. L. Cooke, Deput^y

Recorded this 18th day of Decem^r 1812